

Series 6502C Fixed Lite  
Aluminum Prime Window  
Thermal Master Seal  
New Construction Frame  
with 1" Flange  
Commerical  
F-C70 (6'0x 6'0)  
3 1/4" Frame Depth

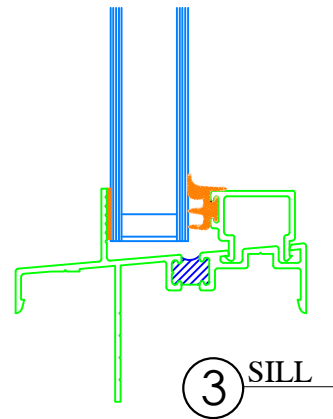

Typical Vert.  
Sectional Details

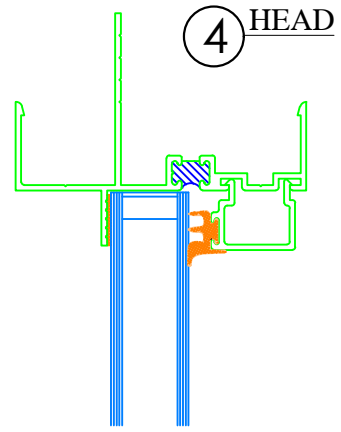
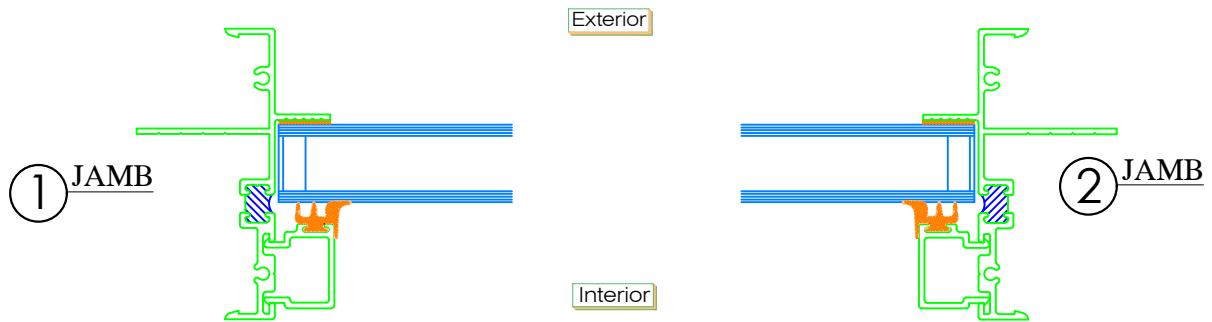

Typical Horiz. Sectional Details

SHEET #	Drawn by:	Customer	Revisions			<b>WINDOW TECH SYSTEMS</b> 15 OLD STONEBREAK ROAD MALTA, NY 12020 800-999-9855 FAX: 518-899-4104 info@windowtechsystems.net
	Checked by:		No.	Date	Description	
	Date:	Project :				
	Scale: 1/2 Scale					