

Series 6000CW Horizontal Slider
 Aluminum Prime Window
 Thermal Master Seal
 Equal Leg Frame
 Commercial
 HS-CWPG50 (71" x 60")
 3 1/4" Frame Depth

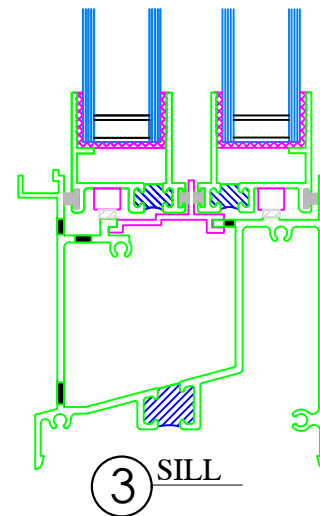

Typical Vert.
Sectional Details

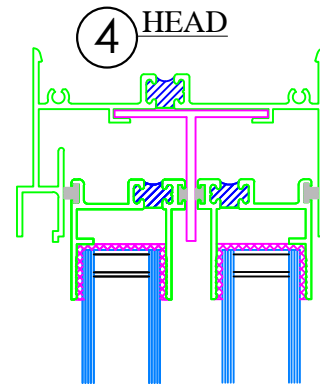
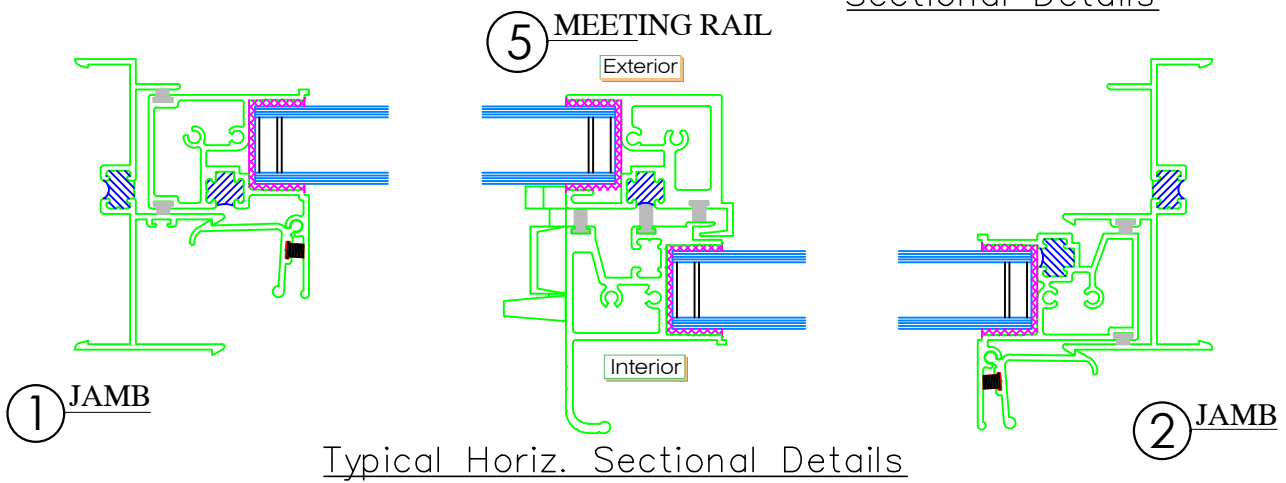

SHEET #	Drawn by:	Customer	Revisions			WINDOW TECH SYSTEMS 15 OLD STONEBREAK ROAD MALTA, NY 12020 800-999-9855 FAX: 518-899-4104 info@windowtechsystems.net
	Checked by:		No.	Date	Description	
	Date:	Project :				
	Scale: 1/2 Scale					