

Series 7500C Fixed Lite  
 Aluminum Prime Window  
 Thermal Master Seal  
 Equal Leg Frame  
 With Horizontal Impost  
 Commercial  
 F-C70 (6'0x 6'0)  
 3 1/4" Frame Depth

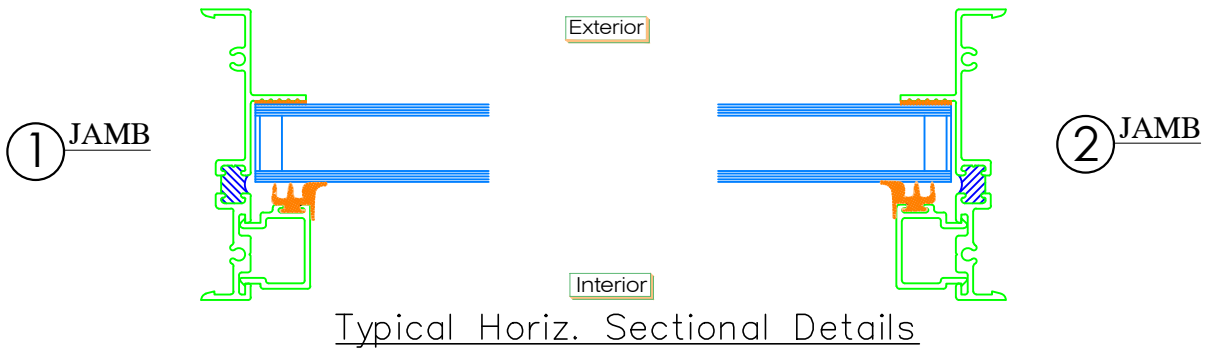
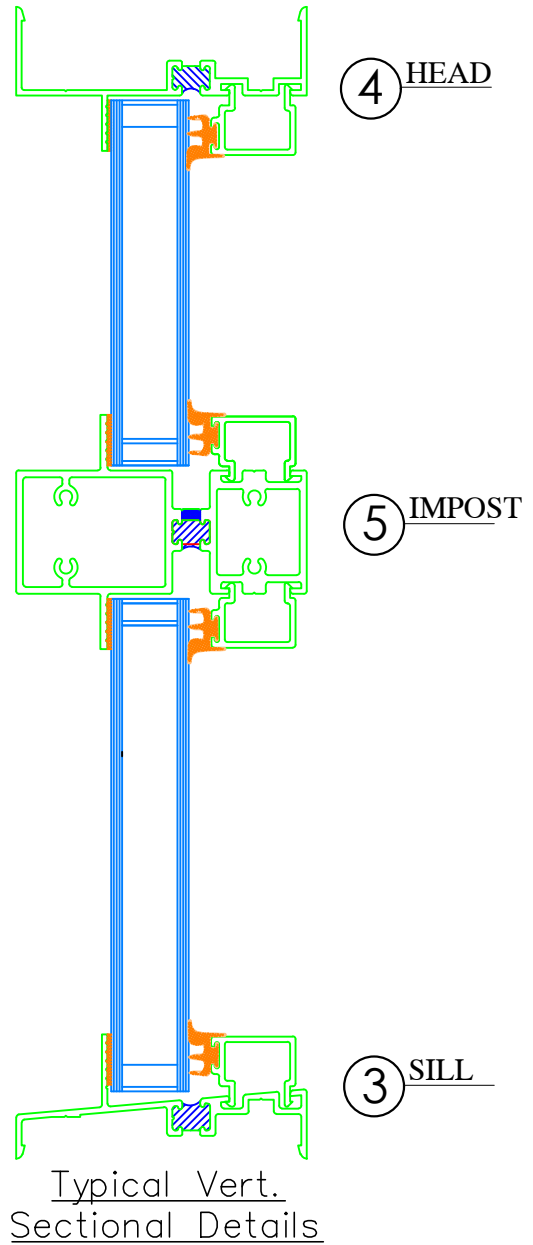

SHEET #	Drawn by:	Customer	Revisions			<b>WINDOW TECH SYSTEMS</b> 15 OLD STONEBREAK ROAD MALTA, NY 12020 800-999-9855 FAX: 518-899-4104 info@windowtechsystems.net
	Checked by:		No.	Date	Description	
	Date:	Project :				
	Scale: 1/2 Scale					